

IR Ingersoll Rand **Series Duralite**

Reversible airmotors
with planetary gearbox



Declaration of Incorporation 

 II 2 GD c IIB 95°C X

Air motors with side air outlet			Air motors with rear air outlet			Max.Power		rpm @		Torque @ max.power		Stall torque		Weight	
Part no.	CPN	L ¹⁾	Part no.	CPN	L ¹⁾	HP	kW	max. power	no load	ft-lbs	Nm	ft-lbs	Nm	lb	kg
22ME-3600-SSR1B	04665006	125	22ME-3600-RSR1B	25013731	149	0,28	0,21	2200	4400	0,7	1,0	1,2	1,6	0,23	0,8
22ME-2250-SSR1B	04664991	125	22ME-2250-RSR1B	25013723	149	0,28	0,21	1450	2900	1	1,4	1,8	2,4	0,23	0,8
22ME-900-SSR1B	04664983	153	22ME-900-RSR1B	25013715	177	0,27	0,20	540	1080	2,6	3,5	4,7	6,4	0,50	1,0
22ME-540-SSR1B	04664975	153	22ME-540-RSR1B	25013707	177	0,27	0,20	340	680	4,2	5,7	7,5	10,2	0,50	1,0
22ME-360-SSR1B	04664967	153	22ME-360-RSR1B	25013699	177	0,25	0,19	210	420	6,5	8,8	11	14,9	0,50	1,0
2202ME-3200-SSR1B	04665162	135	2202ME-3200-RSR1B	25013897	159	0,38	0,28	1800	3600	1,1	1,6	2	2,7	0,32	0,8
2202ME-2000-SSR1B	04665154	135	2202ME-2000-RSR1B	25013889	159	0,38	0,28	1050	2300	1,7	2,3	3	4,1	0,32	0,8
2202ME-750-SSR1B	04665147	163	2202ME-750-RSR1B	25013871	187	0,38	0,28	425	850	4,6	6,3	8,3	11,3	0,45	1,0
2202ME-480-SSR1B	04665139	163	2202ME-480-RSR1B	25013863	187	0,38	0,28	275	550	7,2	9,7	13	17,6	0,45	1,0
2202ME-320-SSR1B	04665121	163	2202ME-320-RSR1B	25013855	187	0,36	0,27	175	350	10,8	14,7	20	27,1	0,45	1,0
33ME-720-SSR4B	04665220	203	---	---	---	0,75	0,56	370	750	10,5	14,2	14,7	19,9	0,82	1,8
33ME-405-SSR4B	04665212	203	---	---	---	0,74	0,55	210	425	18,3	24,8	26,6	36,0	0,82	1,8
33ME-220-SSR4B	04665204	203	---	---	---	0,72	0,54	110	220	34,4	46,6	48,5	65,7	0,82	1,8

¹⁾ - Length of the motor (mm) can vary approx. +/-1 mm due to assembly process. This will also affect "A" dimension on motor drawings.

- Performance data at 620 kPa air pressure. 20 µm filtration or better is recommended.
- Starting torque is approx. 75% of stall torque. Performance at 6,3 bar. All dimensions in mm unless otherwise specified.
- 22ME series: Air consumption 8 L/s (17 cfm) at free speed, 5,7 L/s (12 cfm) at max power. Recommended hose Ø 6 mm (¼")
- 2202ME series: Air consumption 13,5 L/s (24 cfm) at free speed, 8 L/s (17 cfm) at max power. Recommended hose Ø 6 mm (¼")
- 33ME series: Air consumption 18,4 L/s (39 cfm) at free speed, 16,4 L/s (28 cfm) at max power. Recommended hose Ø 12 mm (½")

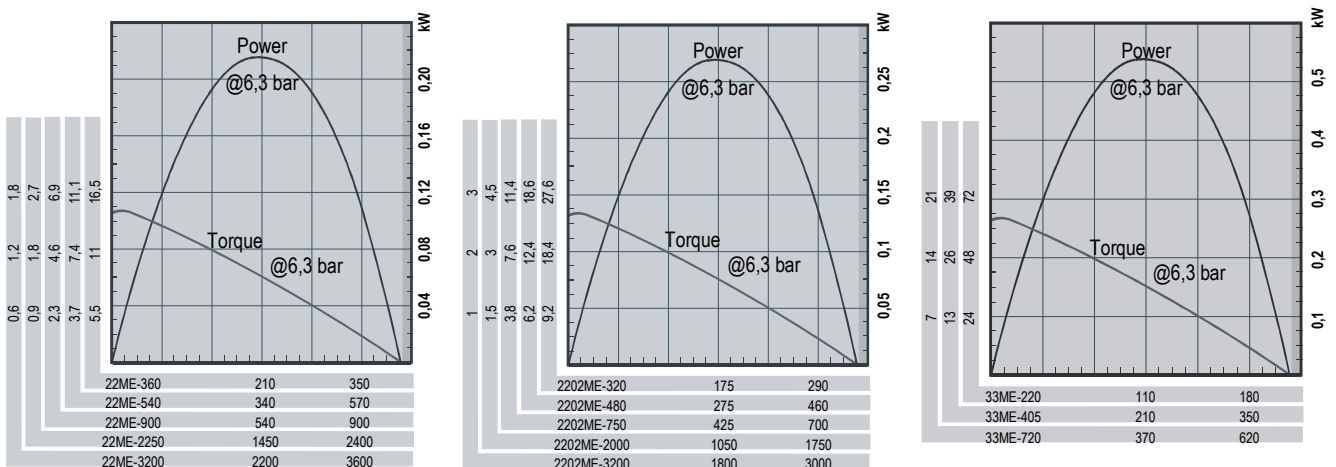

www.ingersollrandproducts.com

Nothing contained on these pages is intended to extend any warranty or representation, expressed or implied, regarding the product described herein. Any such warranties or other terms and conditions of sale of product shall be in accordance with Ingersoll Rand's standard terms and conditions of sale for such products, which are available upon request. Product improvement is a continuing goal at Ingersoll Rand. Design and specification are subject to change without notice or obligation.

© Ingersoll-Rand Company — Form No. PDS_Inline_Duralite_E_2012-02 — Page 1

 **Ingersoll Rand**
Industrial Technologies

IR Ingersoll Rand *Series Duralite*

*Reversible airmotors
with planetary gearbox*

22ME-xxx-RSR1B & 2202ME-xxx-RSR1B – air motors with rear air outlet

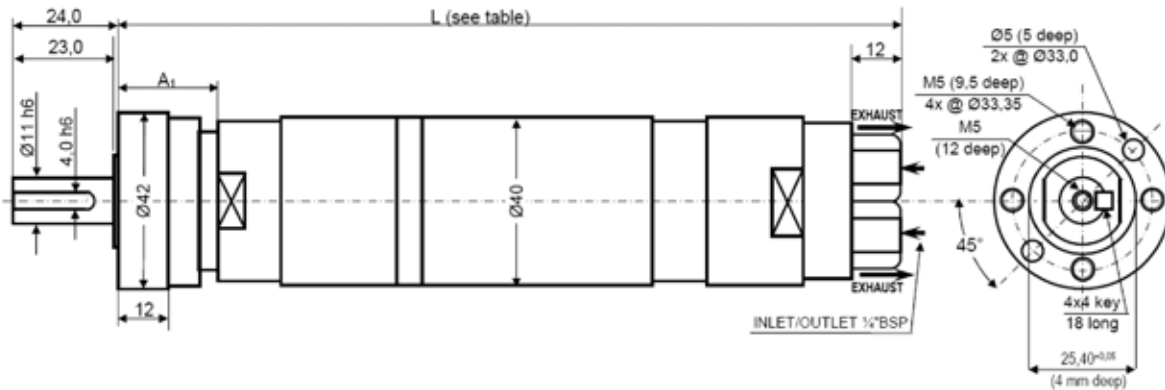

22ME-xxx-SSR1B & 2202ME-xxx-SSR1B – air motors with side air outlet

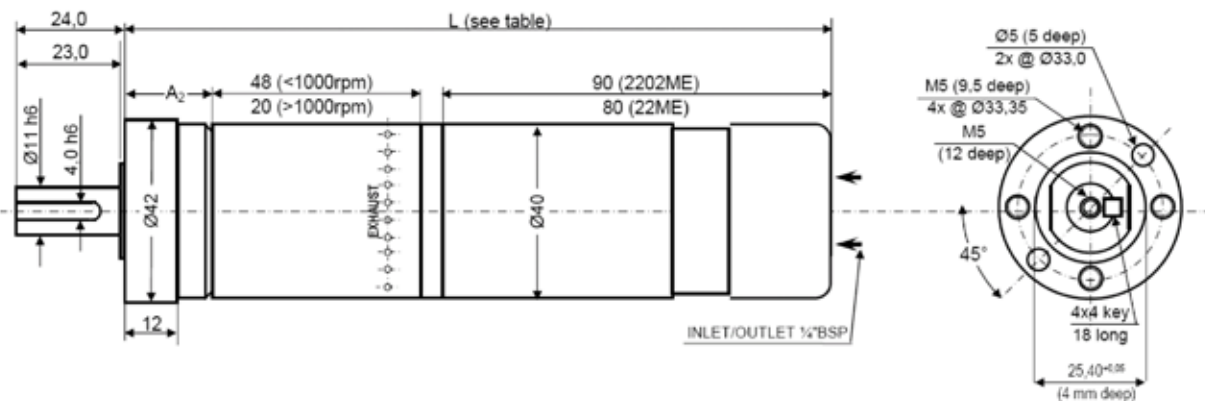

33ME-xxx-SSR4B – air motors with side air outlet

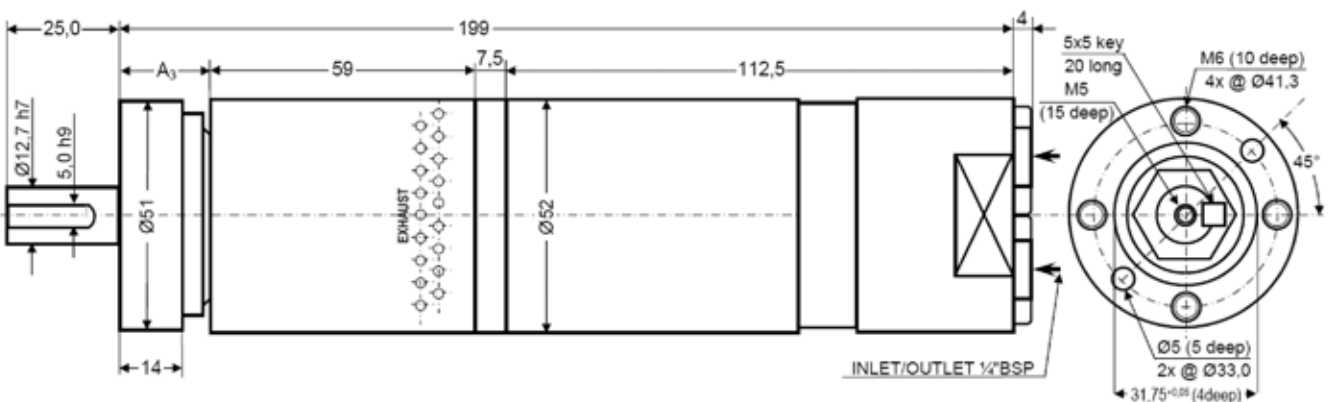



KAVON CZ s.r.o.

Sídlo společnosti:

Smilova 777
530 02 Pardubice

Provozovna:

Medlešice 139
538 31 Chrudim

info@kavon.cz
www.kavon.cz

Pobočky:

Praha

Geologická 2,
152 00 Praha 5
tel./fax.: 222 741 604
mobil: 603 848 716
email: skridlovsky@kavon.cz

Mladá Boleslav

Staré Město 85
293 01 Mladá Boleslav
tel.: 326 322 158
mobil: 736 753 975
email: kavon.mb@kavon.cz

Brno

Hvezdoslavova 55
627 00 Brno-Slatina
tel.: 548 213 068
mobil: 603 893 537
email: simko@kavon.cz